

This map is based upon Ordnance Survey material with the permission of Ordnance Survey on behalf of the Controller of Her Majesty's Stationery Office (c) Crown copyright 2010. Any unauthorised reproduction infringes Crown copyright and may lead to prosecution or civil proceedings. Scottish Executive Licence number: SE100020540 2010.

The A90 (Aberdeen Western Peripheral Route) Special Road  
(Extinguishment of Public Rights of Way) Order 2010

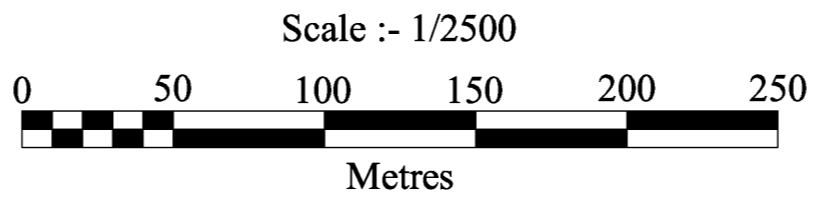

plan  
ROW1



An agency of SCOTTISH EXECUTIVE

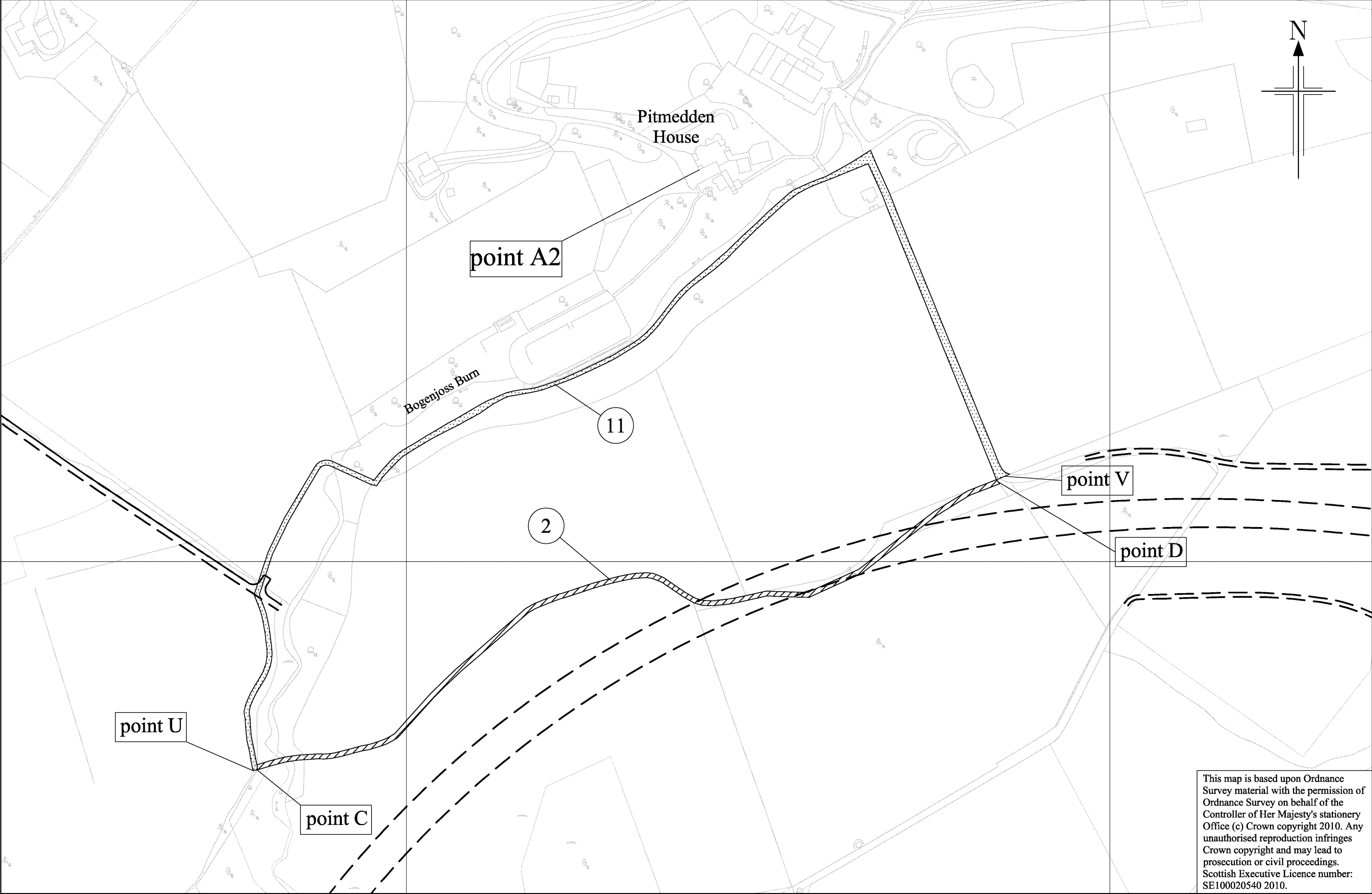

This map is based upon Ordnance Survey material with the permission of Ordnance Survey on behalf of the Controller of Her Majesty's Stationery Office (c) Crown copyright 2010. Any unauthorised reproduction infringes Crown copyright and may lead to prosecution or civil proceedings. Scottish Executive Licence number: SE100020540 2010.

The A90 (Aberdeen Western Peripheral Route) Special Road  
(Extinguishment of Public Rights of Way) Order 2010

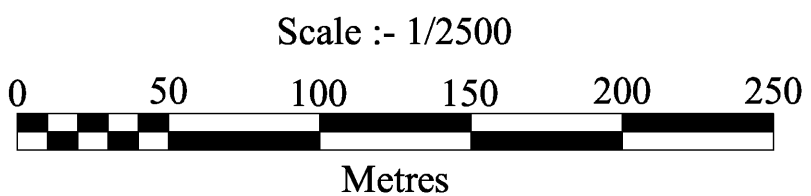

plan  
ROW2



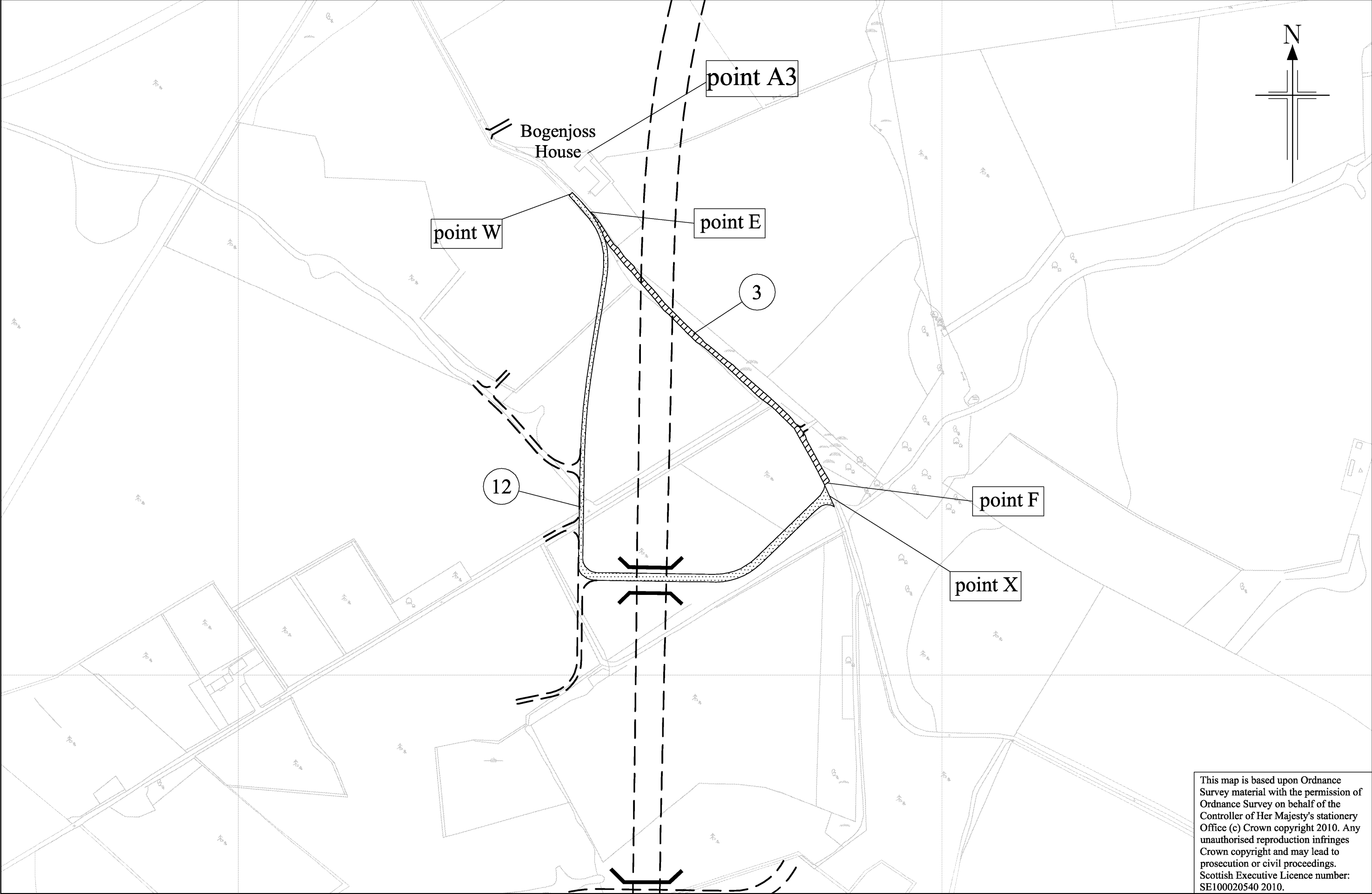

This map is based upon Ordnance Survey material with the permission of Ordnance Survey on behalf of the Controller of Her Majesty's Stationery Office (c) Crown copyright 2010. Any unauthorised reproduction infringes Crown copyright and may lead to prosecution or civil proceedings. Scottish Executive Licence number: SE100020540 2010.

The A90 (Aberdeen Western Peripheral Route) Special Road  
(Extinguishment of Public Rights of Way) Order 2010

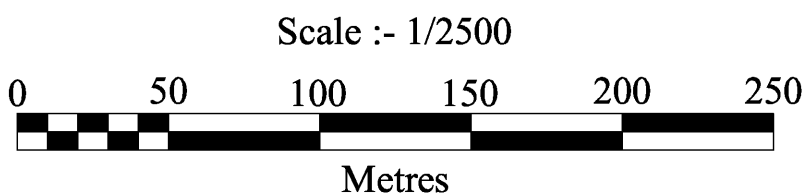

plan  
ROW3



An agency of  SCOTTISH EXECUTIVE

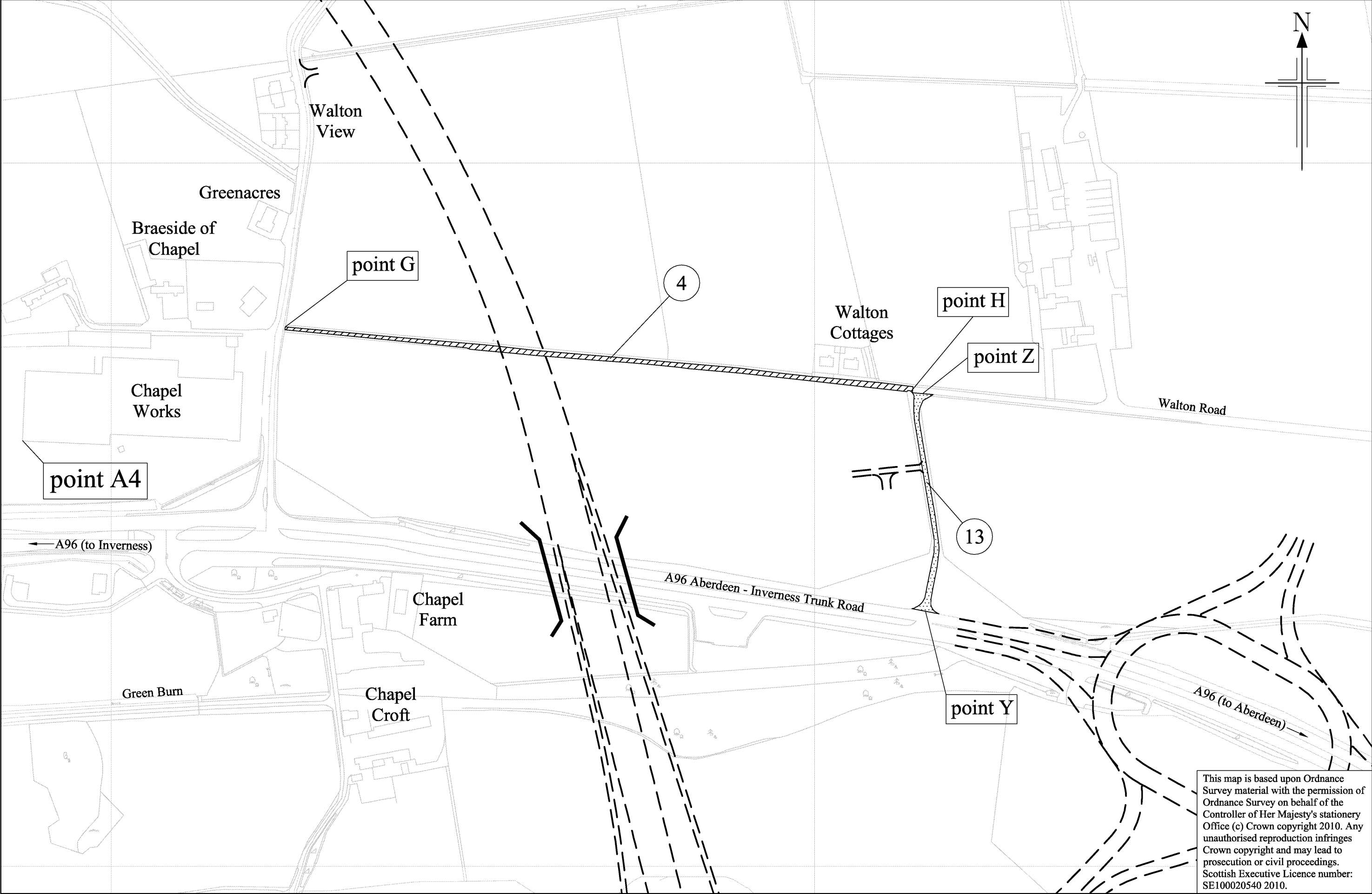
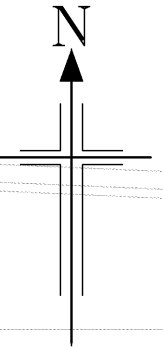

point A4

point G

4

point H

point Z

13

point Y

This map is based upon Ordnance Survey material with the permission of Ordnance Survey on behalf of the Controller of Her Majesty's Stationery Office (c) Crown copyright 2010. Any unauthorised reproduction infringes Crown copyright and may lead to prosecution or civil proceedings. Scottish Executive Licence number: SE100020540 2010.

The A90 (Aberdeen Western Peripheral Route) Special Road  
(Extinguishment of Public Rights of Way) Order 2010

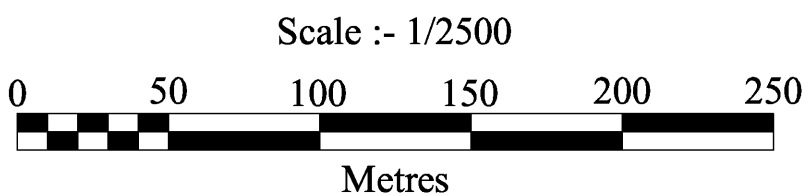

plan  
ROW4



TRANSPORT SCOTLAND  
An agency of SCOTTISH EXECUTIVE

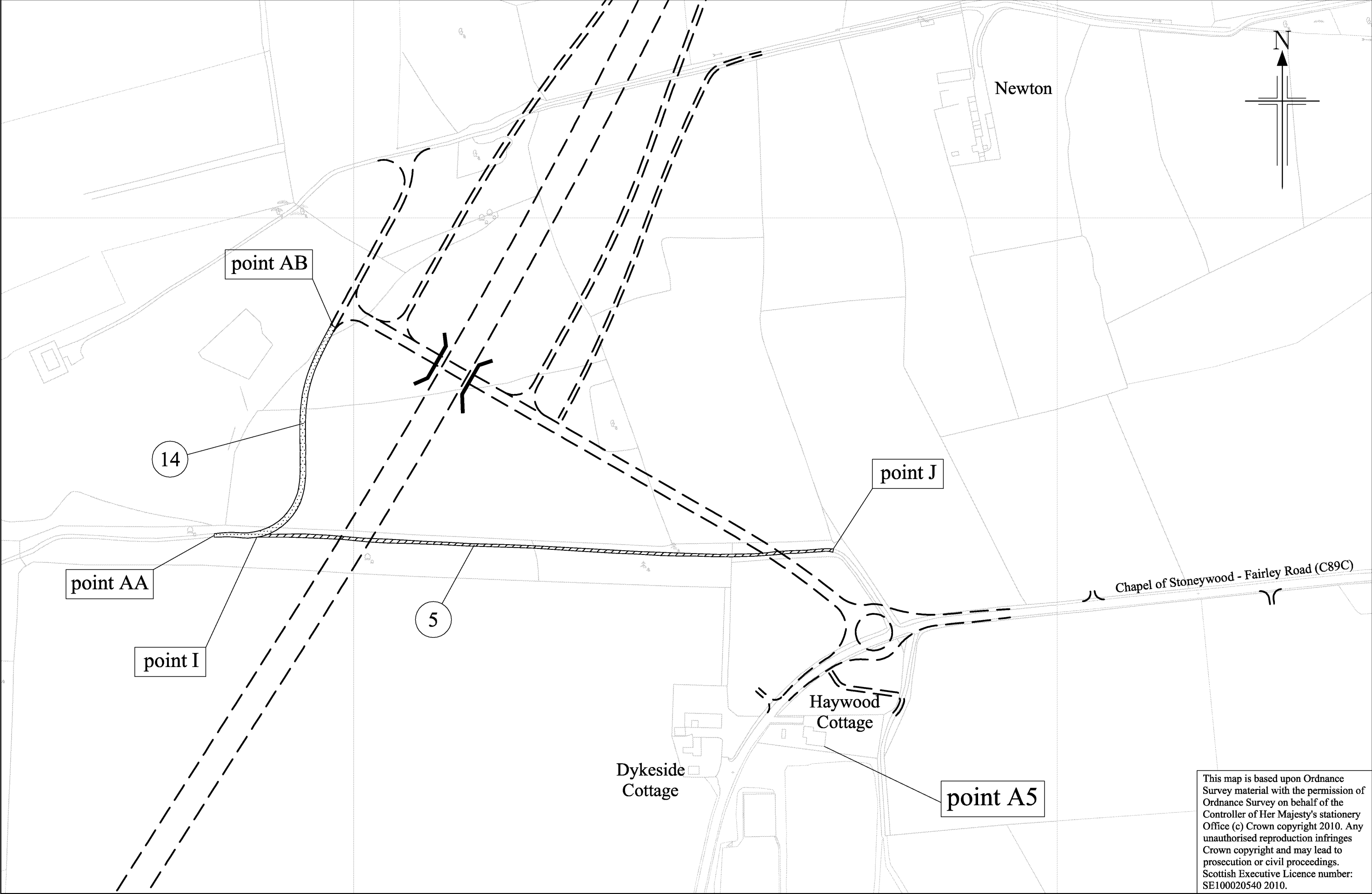

This map is based upon Ordnance Survey material with the permission of Ordnance Survey on behalf of the Controller of Her Majesty's stationery Office (c) Crown copyright 2010. Any unauthorised reproduction infringes Crown copyright and may lead to prosecution or civil proceedings. Scottish Executive Licence number: SE100020540 2010.

The A90 (Aberdeen Western Peripheral Route) Special Road  
(Extinguishment of Public Rights of Way) Order 2010

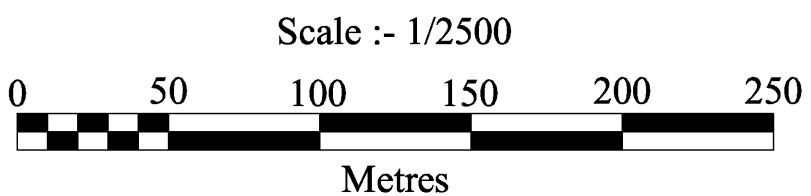

plan  
ROW5



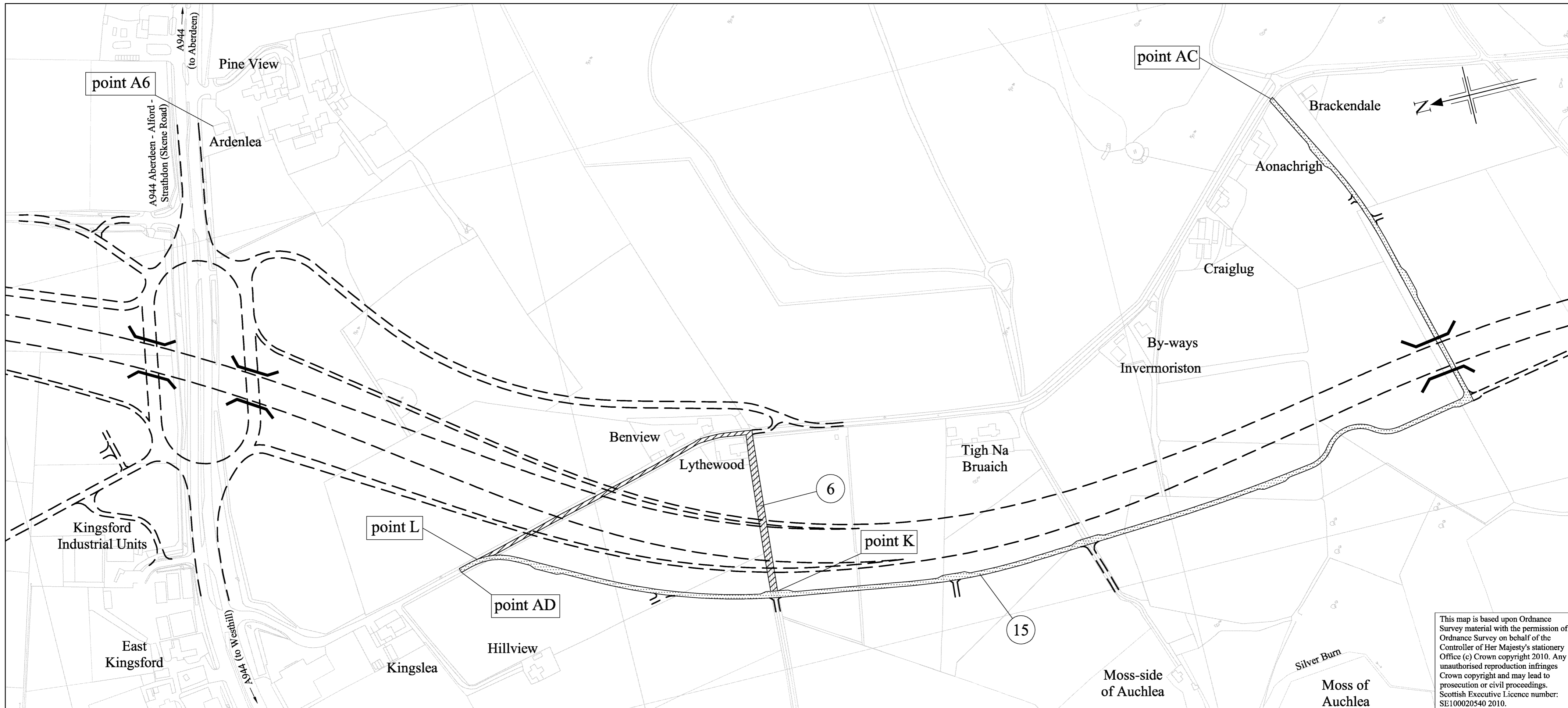

This map is based upon Ordnance Survey material with the permission of Ordnance Survey on behalf of the Controller of Her Majesty's Stationery Office (c) Crown copyright 2010. Any unauthorised reproduction infringes Crown copyright and may lead to prosecution or civil proceedings. Scottish Executive Licence number: SE100020540 2010.

The A90 (Aberdeen Western Peripheral Route) Special Road  
(Extinguishment of Public Rights of Way) Order 2010

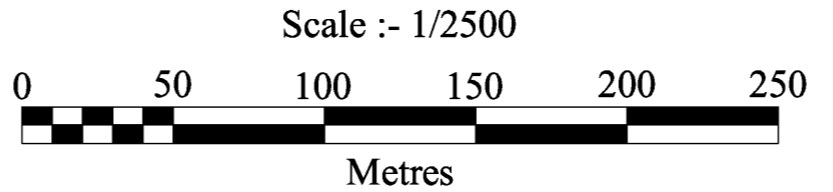

plan  
ROW6



An agency of SCOTTISH EXECUTIVE

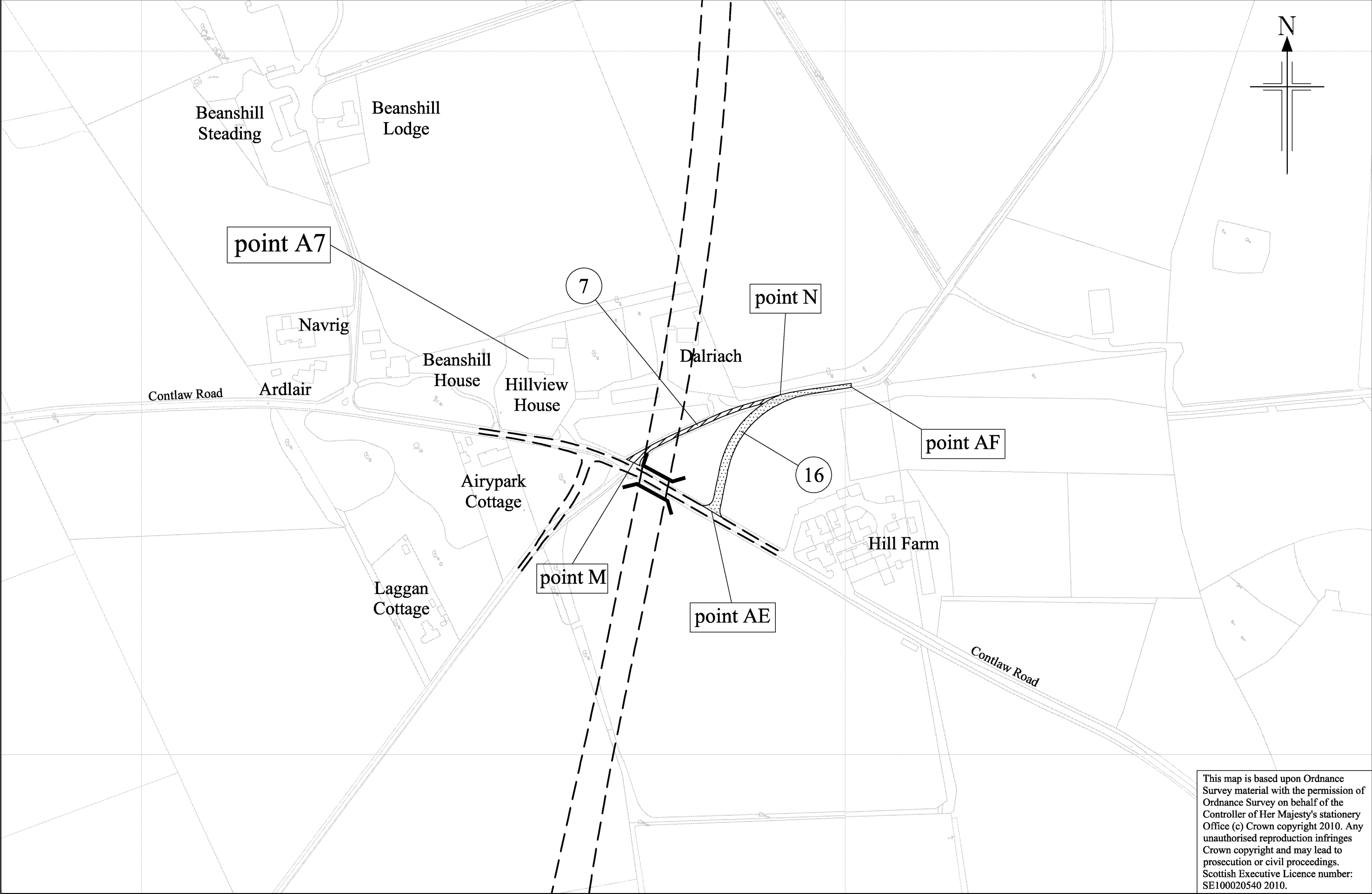

This map is based upon Ordnance Survey material with the permission of Ordnance Survey on behalf of the Controller of Her Majesty's Stationery Office (c) Crown copyright 2010. Any unauthorised reproduction infringes Crown copyright and may lead to prosecution or civil proceedings. Scottish Executive Licence number: SE100020540 2010.

The A90 (Aberdeen Western Peripheral Route) Special Road  
(Extinguishment of Public Rights of Way) Order 2010

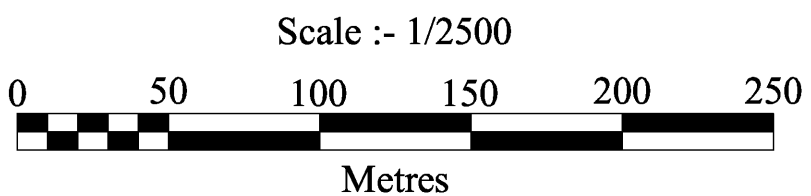

plan  
ROW7



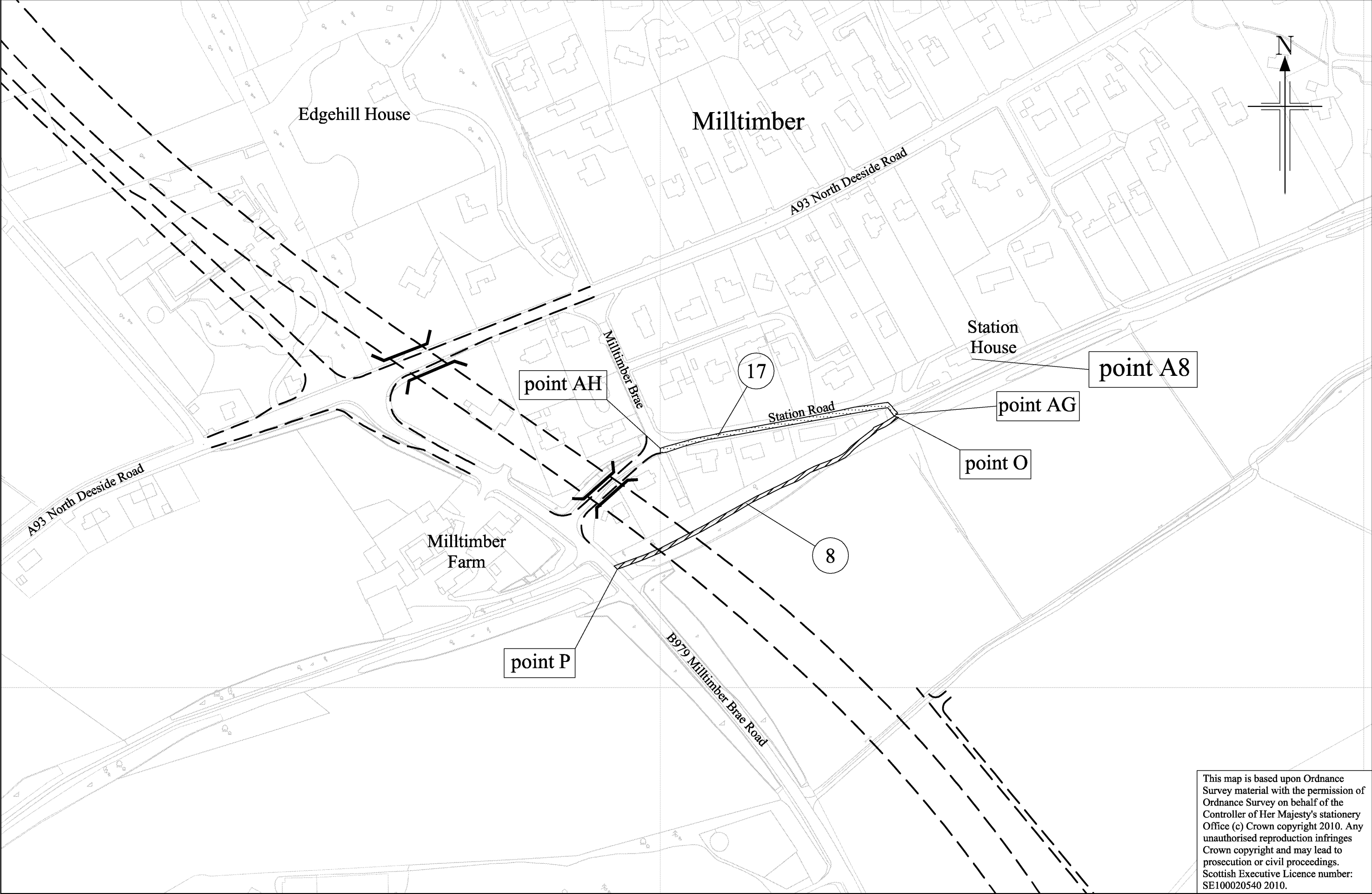

This map is based upon Ordnance Survey material with the permission of Ordnance Survey on behalf of the Controller of Her Majesty's Stationery Office (c) Crown copyright 2010. Any unauthorised reproduction infringes Crown copyright and may lead to prosecution or civil proceedings. Scottish Executive Licence number: SE100020540 2010.

The A90 (Aberdeen Western Peripheral Route) Special Road  
(Extinguishment of Public Rights of Way) Order 2010

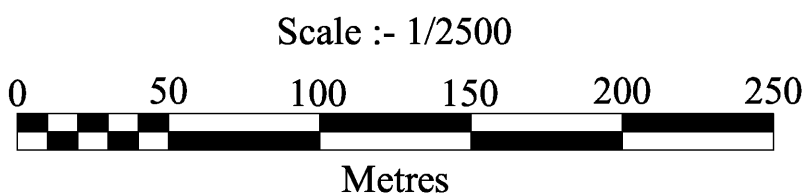

plan  
ROW8





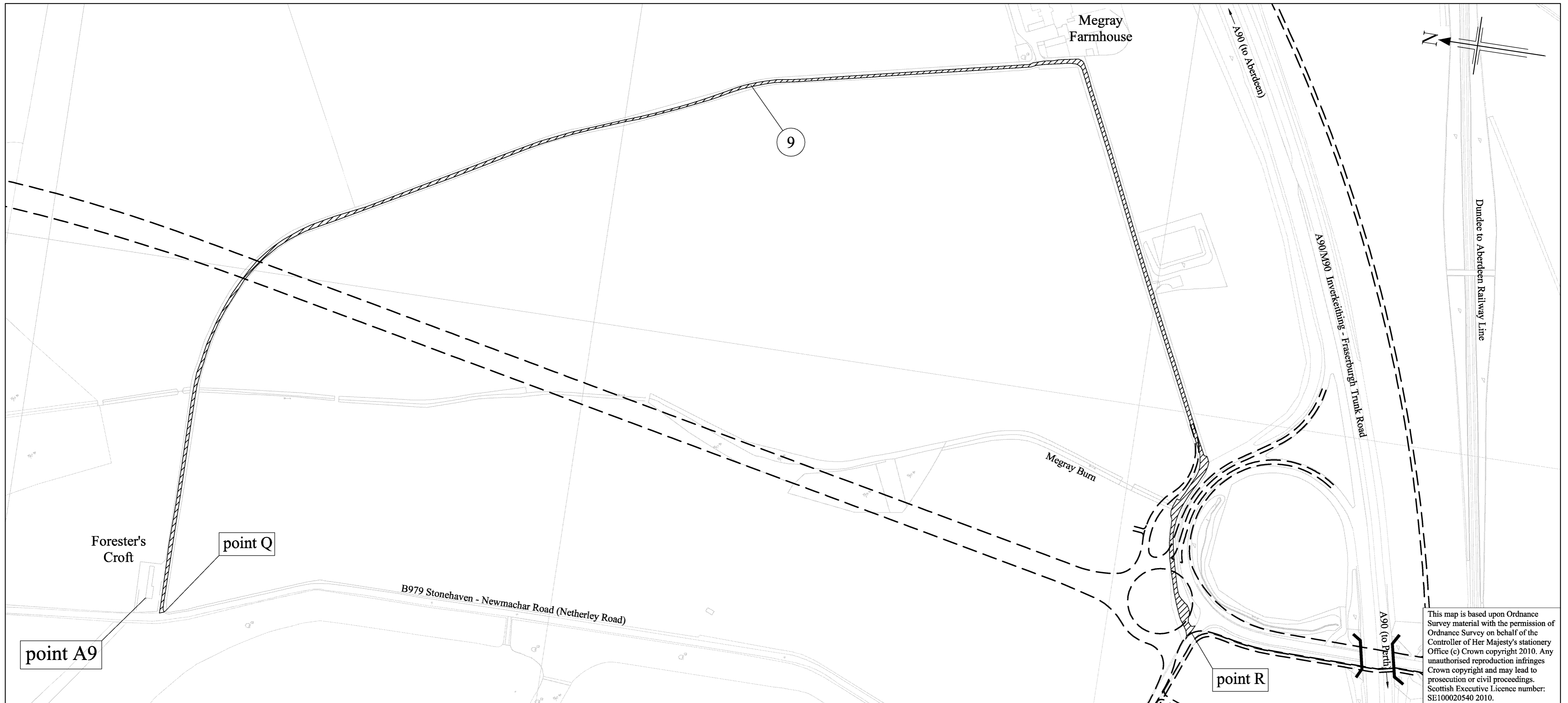

point A9

point Q

point R

Megray Farmhouse

Forester's Croft

Megray Burn

B979 Stonehaven - Newmachar Road (Netherley Road)

A90N90 Inverkeithing - Fraserburgh Trunk Road

Dundee to Aberdeen Railway Line

This map is based upon Ordnance Survey material with the permission of Ordnance Survey on behalf of the Controller of Her Majesty's Stationery Office (c) Crown copyright 2010. Any unauthorised reproduction infringes Crown copyright and may lead to prosecution or civil proceedings. Scottish Executive Licence number: SE100020540 2010.

The A90 (Aberdeen Western Peripheral Route) Special Road  
(Extinguishment of Public Rights of Way) Order 2010

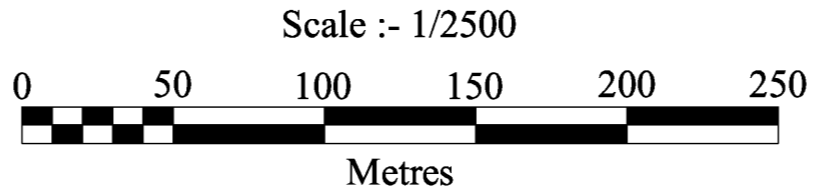

plan  
ROW9

